

The Emmbrook School Expansion

Community Consultation
December 2022



HLM
Architects



1. New 6th Form Social and Study Building

Wokingham Borough Council is working with a number of schools, including the Emmbrook School, to provide additional school places, to address the shortfall in secondary Year 7 places.

Enhanced accommodation, with additional classrooms are planned to enable additional pupils to be admitted.

Following a review of the current accommodation, the following building works are planned:

- A new reception extension to the existing school
- A new two- storey modular sixth form block
- Remodelling and landscaping works to create new wheelchair access routes through the school
- Remodelling the existing 6th Form Centre into a new larger dining area
- Demolition of the existing school admin block to create additional car parking capacity.

To give you the opportunity to see the plans of the works an open evening is being held at the school on:

Wednesday 7th December 2022 at 6.30pm-8.00pm



2. New Admin/Welcome Entrance to the Main School



3. Reconfiguration of existing walkway and courtyard.

Site Plan

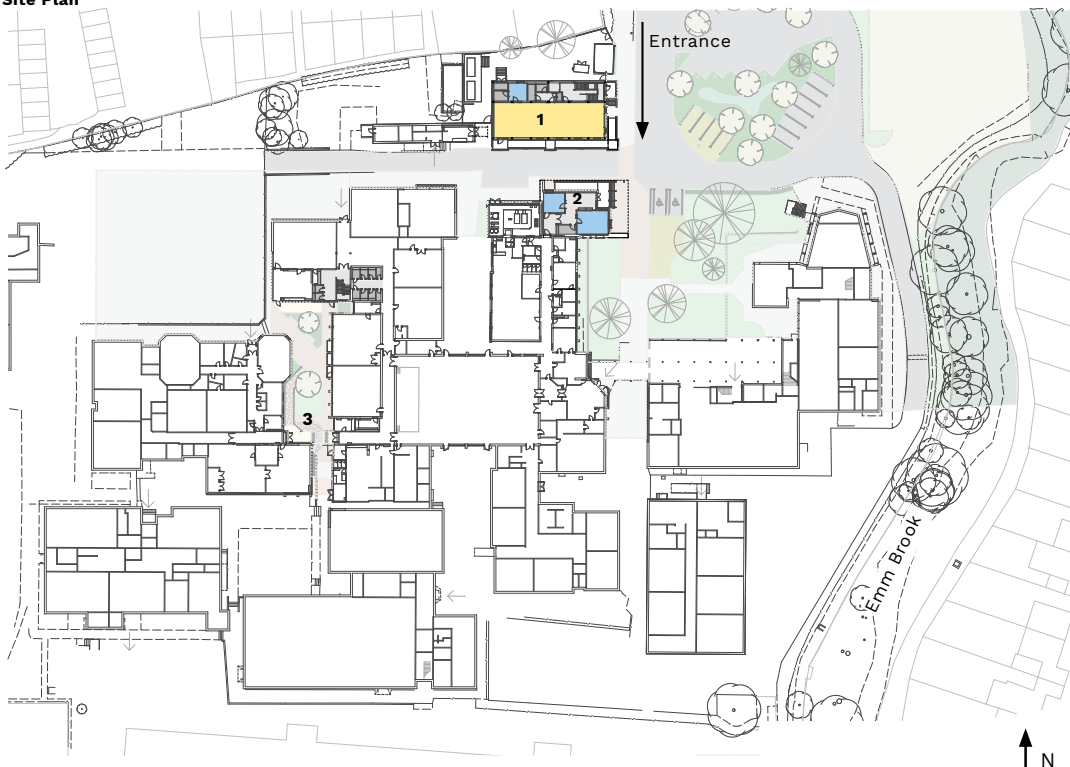

Head Teacher:
Nick McSweeney

Site Address:
Emmbrook Rd, Wokingham
RG41 1JP